

CUSTOMER INSTRUCTIONS FOR RETURNING HOLOGIC PRODUCTS

This Return Kit Contains:

- Bubble Wrap (Wrap product in and place into White Internal Box)
- 1 Clear Resealable Bag for White Internal Box
- 1 Red Biohazard Bag that goes inside the White Internal Box
- 2 Shipping Boxes (White Internal Box and RMA Product Return Shipping Box)
- 1 Cardboard Divider
- Outer Shipping Box (To be discarded after opening)
- 1 International Pre-Printed FedEx Airbill for IBS Units (Except for TruNode Probe, TruNode UFU, ATEC, Eviva and Brevera Biopsy System Adapters, LOCALizer, Mini-LOC, Mammosite and Contura Products).
- 1 International Pre-Printed FedEx Airbill for Products going to Hologic Costa Rica.

Instructions for packaging:

Outer Shipping Box (Not to be reused) RMA Product Return Shipping Box White Internal box



1. Empty any remaining fluid from the device as best as possible without damaging the device.
2. Carefully **place the protective sheath on the device tip** and place the device back in the original product tray (if applicable). Do not use staples to seal product packaging. The staples can cause a puncture hazard.
3. Place the device into the **Red Biohazard Bag** (primary bag) and seal the bag with tape or wire tie only.
4. Place the bagged device on top of the **Cardboard Divider**. Use **Bubble Wrap** as needed to fill remaining empty space.

Hologic Product Returns

RMA Instructions

5. Close the **Internal White Box** and secure the lid completely. Place the Internal White Box inside the **Clear Re-Sealable Bag**.



6. Remove as much air as possible before sealing. Insert Internal White Box into the **Product Return RMA Shipping Box** and tape box closed.



7. Complete the **box for shipping to Hologic Inc.**

- ◇ **Write your RMA number on the Product Return Shipping Box.**
- ◇ Your RMA number will be provided to you by Hologic after receiving the complaint.
- ◇ Use the FedEx Airbill sent by Hologic Technical Support or use the applicable international FedEx Airbill. (only applicable countries outside U.S Continental, OCONUS). Call Hologic Technical Support if needed.
- ◇ If you are returning a TruNode Probe, TruNode UFU, ATEC, Eviva or Brevera Biopsy System Adapters, a LOCALizer or a Mini-LOC reader, probe or tag applicator, a Mammosite or a Contura and you are from a country outside of U.S. Continental please use the international FedEx Airbill that contains Hologic Costa Rica address. If you are returning any other unit please use the international FedEx Airbill that contains Steri-Tek address.

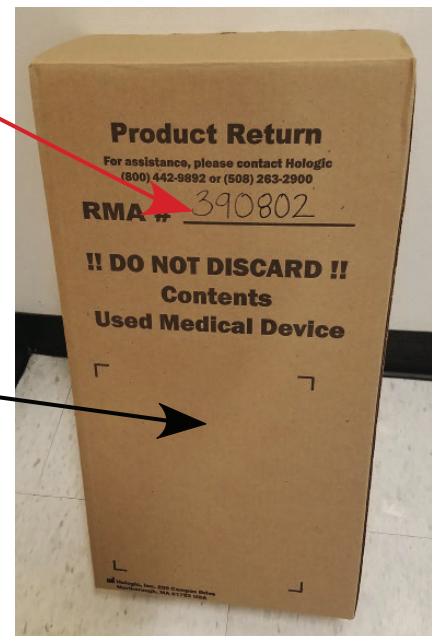

If you have any questions about this procedure, contact Hologic: Hologic, Inc. (877) 371-4372